

(CONCEPTUAL PLAN)
PARKING ALTERNATE PLAN "E"
 (42 SPACES, 18' AISLES)
 EAST HAMPTON LIBRARY

S.C. TAX No. 301-08-03-29.1

SCALE 1"=20'

NOVEMBER 10, 2009

JANUARY 6, 2010 REVISED PROPOSED PARKING SPACES TO 10' X 18' DIMENSION & RECALCULATE PROPOSED PARKING AREA
 JANUARY 12, 2010 REVISED PROPOSED PARKING AREA & DRIVEWAY
 FEBRUARY 13, 2010 REVISED PROPOSED PARKING AREA & DRIVEWAY

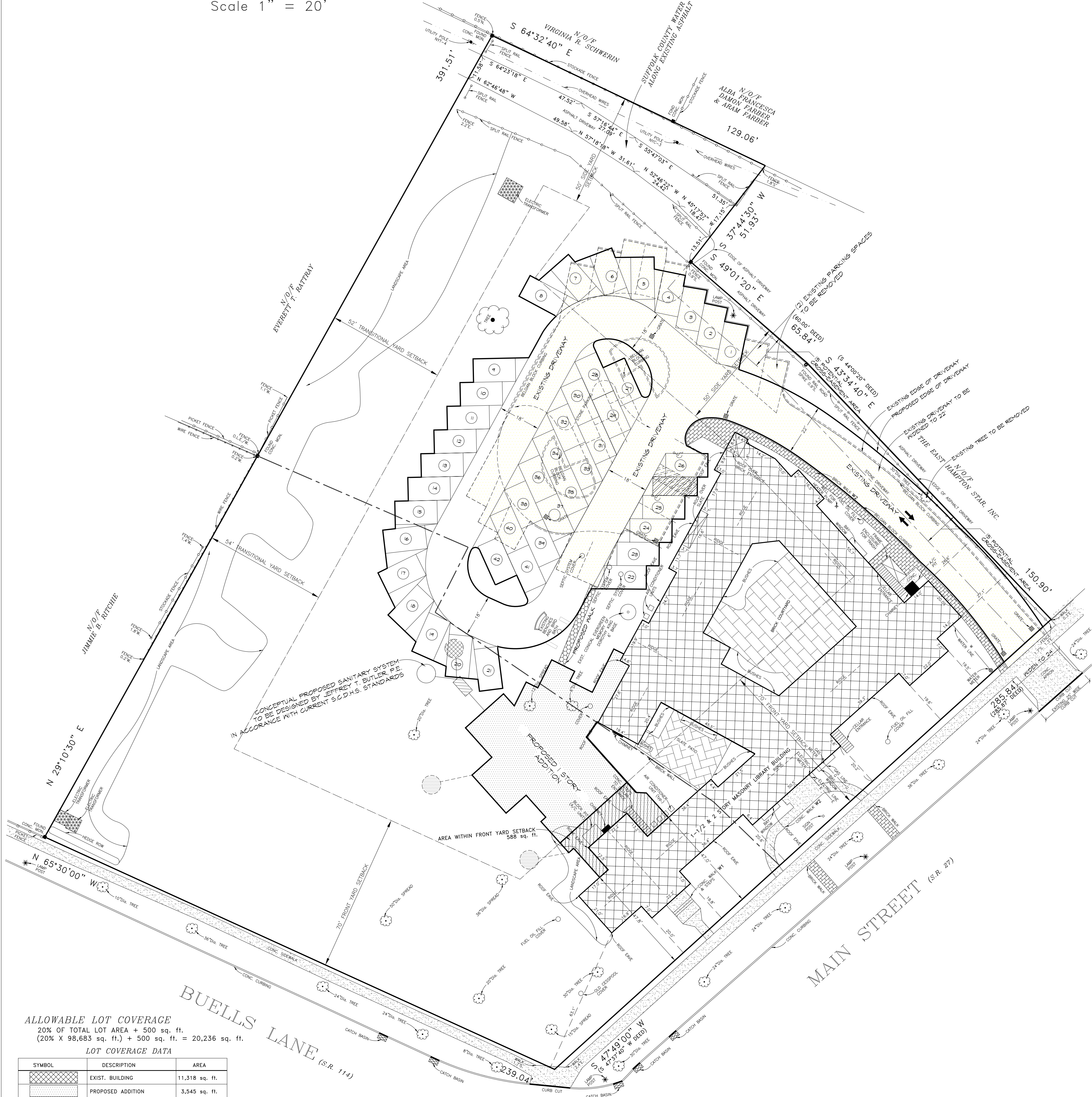
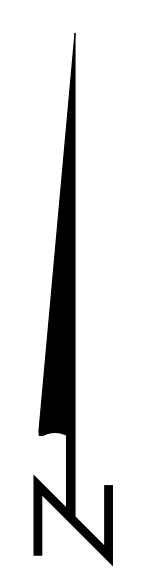
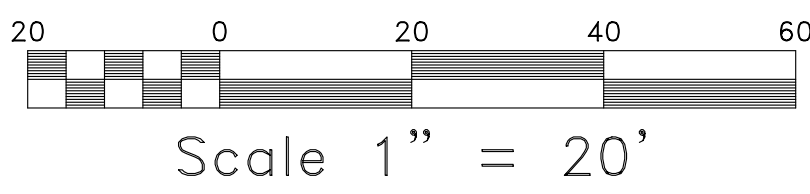

ALLOWABLE LOT COVERAGE
 20% OF TOTAL LOT AREA + 500 sq. ft.
 (20% X 98,683 sq. ft.) + 500 sq. ft. = 20,236 sq. ft.

LOT COVERAGE DATA

SYMBOL	DESCRIPTION	AREA
[Hatched Box]	EXIST. BUILDING	11,318 sq. ft.
[Dotted Box]	PROPOSED ADDITION	3,545 sq. ft.
[Horizontal Lines]	EXIST. CONC. WALK W1	167 sq. ft.
[Vertical Lines]	EXIST. CONC. WALK W2	363 sq. ft.
[Diagonal Lines]	EXIST. BRICK WALK W3	767 sq. ft.
[Cross-hatch]	EXIST. SLATE PATIO*	628 sq. ft.
[Stippled]	EXIST. BRICK COURTYARD*	1,862 sq. ft.
[Dotted]	PROPOSED WALK	110 sq. ft.
[Small Circles]	EXIST. (3) TRANSFORMERS	124 sq. ft.
	TOTAL	18,884 sq. ft.

- NOTES:**
- UNDERGROUND STRUCTURES & UTILITIES AS PER THE LIBRARY STAFF.
 - ELEVATIONS ARE REFERENCED TO AN ASSUMED DATUM
 EXISTING ELEVATIONS ARE SHOWN THUS:
 - FIRST FLOOR
 - TOP OF CURB
 - BOTTOM OF CURB
 - PROPOSED SEPTIC SYSTEM SHOWN THUS:
 [Symbol] PROPOSED EXPANSION POOL
 [Symbol] PROPOSED LEACHING POOL
 [Symbol] PROPOSED SEPTIC TANK

PARKING & DRIVEWAY CALCULATIONS

	EXISTING	PROPOSED	TOTAL AFTER CONSTRUCTION
PARKING	4,730 sq. ft.	5,400 sq. ft.	10,130 sq. ft.
DRIVEWAY	7,690 sq. ft.	2,740 sq. ft.	10,430 sq. ft.
TOTAL	12,420 sq. ft.	8,140 sq. ft.	20,560 sq. ft.

CALCULATION SHOWING REMAINING OPEN SPACE

TOTAL LOT AREA	98,683 sq. ft.
EXISTING BUILDING, PARKING, DRIVEWAY, CLOISTER GARDEN, COURTYARDS & WALKS	28,554 sq. ft.
EXISTING LAWN & OPEN SPACE	70,129 sq. ft.
PROPOSED BUILDING FOOTPRINT & WALKWAY	3,655 sq. ft. [5%]
PROPOSED ADDITIONAL 16 PARKING SPACES & DRIVEWAY	8,140 sq. ft. [11%]

PERCENT OF NEW BUILDING & PARKING OVER EXISTING LAWN & OPEN SPACE	16%
PERCENT OF EXISTING LAWN & OPEN SPACE PRESERVED	84%

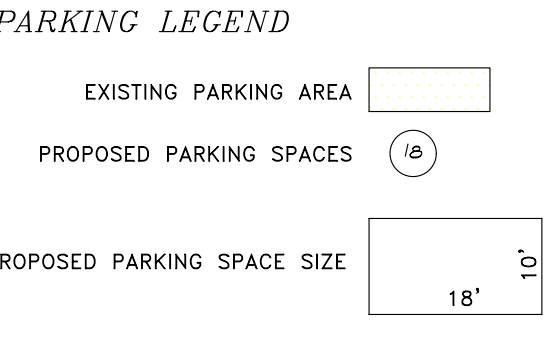

DRAINAGE SYSTEM CALCULATIONS:
 ROOF AREA FOR PROPOSED ADDITION: 3,545 sq. ft.
 3,545 sq. ft. X 0.25 = 887 sq. ft.
 887 cu. ft. / 42.2 = 22 vertical ft. of 8' dia. leaching pool required
 PROVIDE (2) 8' dia. X 11' high STORM DRAIN POOLS
 PROPOSED 8' DIA. X 11' DEEP DRYWELLS FOR ROOF RUN-OFF ARE SHOWN THUS:

UNAUTHORIZED ALTERATION OR ADDITION TO THIS SURVEY IS A VIOLATION OF SECTION 7209 OF THE NEW YORK STATE EDUCATION LAW.
 COPIES OF THIS SURVEY MAP NOT BEARING THE LAND SURVEYOR'S INKED SEAL OR EMBOSSED SEAL SHALL NOT BE CONSIDERED TO BE A VALID TRUE COPY.
 CERTIFICATIONS INDICATED HEREON SHALL RUN ONLY TO THE PERSON FOR WHOM THE SURVEY IS PREPARED, AND ON HIS BEHALF TO THE TITLE COMPANY, GOVERNMENTAL AGENCY AND LENDING INSTITUTION LISTED HEREON, AND TO THE ASSIGNEES OF THE LENDING INSTITUTION. CERTIFICATIONS ARE NOT TRANSFERABLE.

THE EXISTENCE OF RIGHT OF WAYS AND/OR EASEMENTS OF RECORD, IF ANY, NOT SHOWN ARE NOT GUARANTEED.
 PREPARED IN ACCORDANCE WITH THE MINIMUM STANDARDS FOR TITLE SURVEYS AS ESTABLISHED BY THE L.L.A.S. AND APPROVED AND ADOPTED FOR SUCH USE BY THE NEW YORK STATE LAND TITLE ASSOCIATION.

N.Y.S. Lic. No. 50467

Nathan Taft Corwin III
Land Surveyor

Title Surveys - Subdivisions - Site Plans - Construction Layout
 PHONE (631)727-2090 Fax (631)727-1727
 OFFICES LOCATED AT MAILING ADDRESS
 1586 Main Road P.O. Box 16
 Jamesport, New York 11947 Jamesport, New York 11947